

\$289,900 - 6a 53030 Rge Rd 20, Rural Parkland County

MLS® #E4431997

\$289,900

0 Bedroom, 0.00 Bathroom,
Rural on 2.87 Acres

Bell Acres, Rural Parkland County, AB

Build your dream home on this beautiful 2.87-acre vacant lot in Bell Acres. Surrounded on three sides by a mature shelter belt featuring majestic blue spruce trees, this property offers privacy, natural beauty, and a serene atmosphere. Enjoy direct access to greenspace and walking trails that lead to Blueberry School—perfect for families. Conveniently located near Yellowhead Hwy, Highway 16A, and Parkland Drive, commuting is a breeze while still enjoying the peace of country living. This is a rare opportunity to own a mature lot with space to grow and explore. Don't miss your chance to break ground this year!

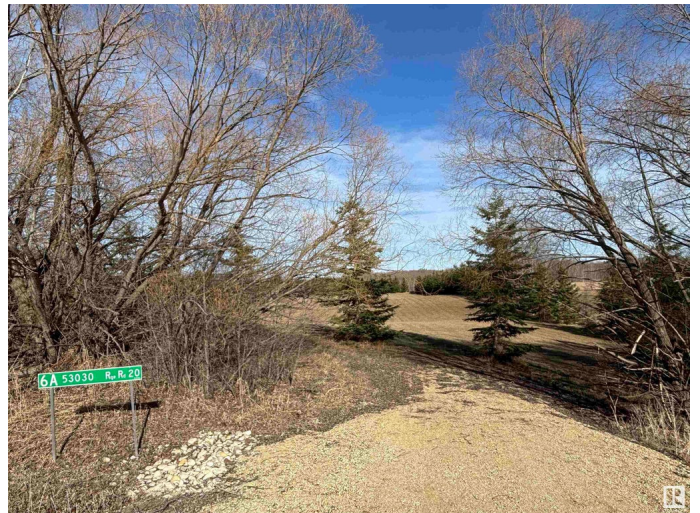

Essential Information

| | |
|-----------|-----------------|
| MLS® # | E4431997 |
| Price | \$289,900 |
| Bathrooms | 0.00 |
| Acres | 2.87 |
| Type | Rural |
| Sub-Type | Vacant Lot/Land |
| Status | Active |

Community Information

| | |
|---------|-----------------------|
| Address | 6a 53030 Rge Rd 20 |
| Area | Rural Parkland County |

Subdivision Bell Acres
City Rural Parkland County
County ALBERTA
Province AB
Postal Code T7Y 2G8

Exterior

Exterior Features Backs Onto Park/Trees, Environmental Reserve, Landscaped, Private Setting, Schools, See Remarks

Additional Information

Date Listed April 20th, 2025
Days on Market 5
Zoning Zone 90

DATA IS DEEMED RELIABLE BUT IS NOT GUARANTEED ACCURATE BY THE REALTORS® ASSOCIATION OF EDMONTON. COPYRIGHT 2025 BY THE REALTORS® ASSOCIATION OF EDMONTON. ALL RIGHTS RESERVED. Trademarks are owned or controlled by the Canadian Real Estate Association (CREA) and identify real estate professionals who are members of CREA (REALTOR®, REALTORS®) and/or the quality of services they provide (MLS®, Multiple Listing Service®)

Listing information last updated on April 25th, 2025 at 1:47pm MDT